

Instructions for Models:

SB-1131
SB-1131-BN
SB-1131-PN

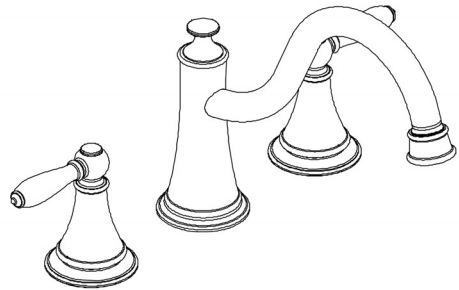

Need Help?

For additional assistance or service call:

SPEAKMAN Company
400 Anchor Mill Road
New Castle, DE 19720

PHONE: 800-537-2107
EMAIL: customerservice@speakmancompany.com
WEB: www.speakmancompany.com

92-3408-R1

What You Need To Know:

Tools:

Required:

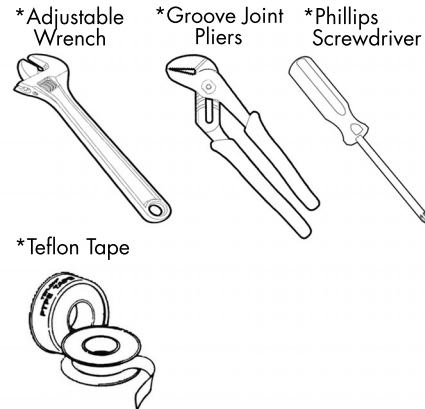

Helpful:

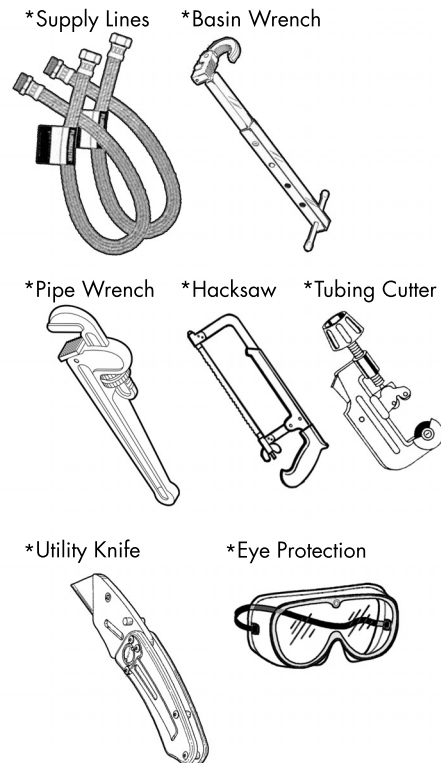

What You Need To Know:

Important Notes:

Be sure to read instructions thoroughly before beginning installation. Do not overtighten any connections or damage may occur. This faucet has an operating range of 20-80 psi.

Safety Tips:

Cover your drain to prevent loss of parts.

Be sure to wear eye protection while cutting pipe.

Maintenance:

Your new Roman Tub Faucet is designed for years of trouble-free performance. Keep it looking new by cleaning it periodically with a soft cloth. Avoid abrasive cleaners, steel wool, and harsh chemicals as these will dull the finish and void your warranty.

- 3** Thread handle assembly ① onto valve stem ②. Secure handle with screw ③. Insert index ④.

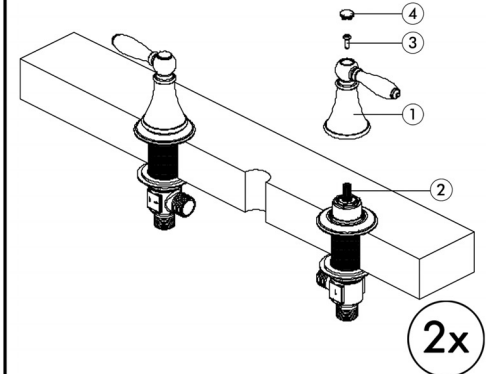

- 1** Drill holes in finished deck per diagram.
Note:
This system is intended for installations up to 2" thick.

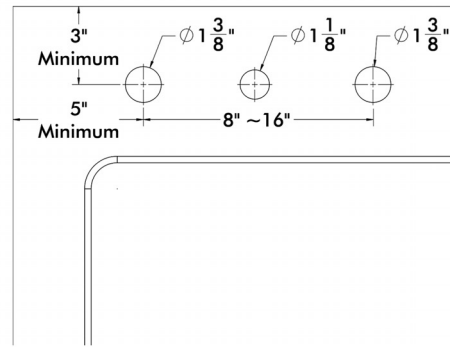

- 4** From underneath the tub deck, insert middle body with rubber washer ①, metal washer ②, and mounting nut ③ thru mounting hole. From above, thread connector ④ onto middle body. Tighten mounting nut ③, until connector ④ sits flush to the top surface of the tub deck.

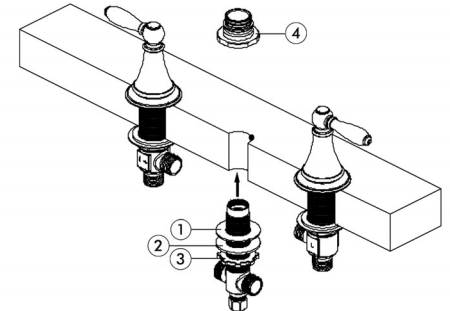

- 2** From underneath the deck, insert valve body with rubber washer ①, metal washer ②, and mounting nut ③, through holes on the right (COLD) side. From above, thread flange ④ onto valve stem. Tighten mounting nut ③, so that the flange ④ sits flush to the surface of working area. Repeat for left (HOT) side.
Note: HOT side end valve is labeled.

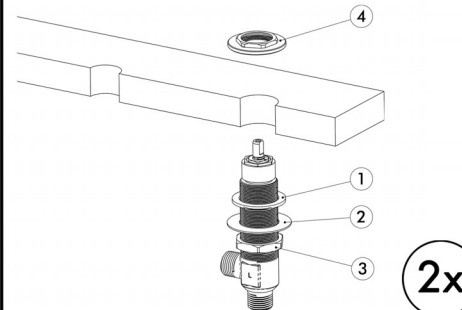

- 5** Assemble and align spout ① onto connector ② and secure spout with set screw ③. Insert button ④.

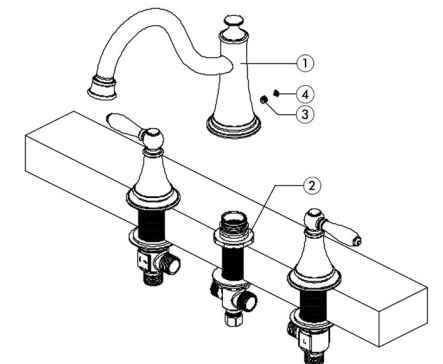

- 6 Connect water supply lines ① to faucet inlets ②
NOTE: Supply lines are not included.

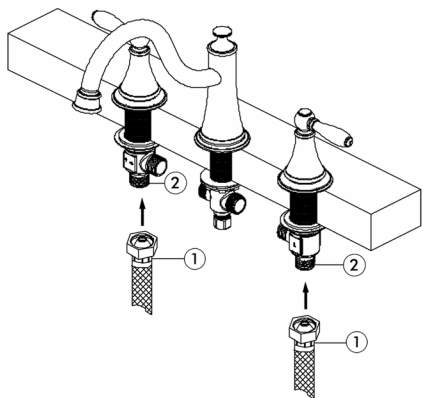

- 7 Connect the flexible water supply hose ① (included) to the bottom of valve bodies ② as shown. Align middle body ③ to a position which will allow maximum clearance to connect hoses. Carefully bend hoses to fit available space. Thread the hose couplings to the sides of the middle body ③.

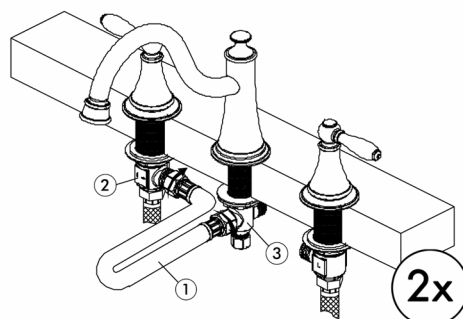

- 8 **IMPORTANT:**
After installation is completed, turn on water supply and allow both hot and cold water to run for at least one minute each.

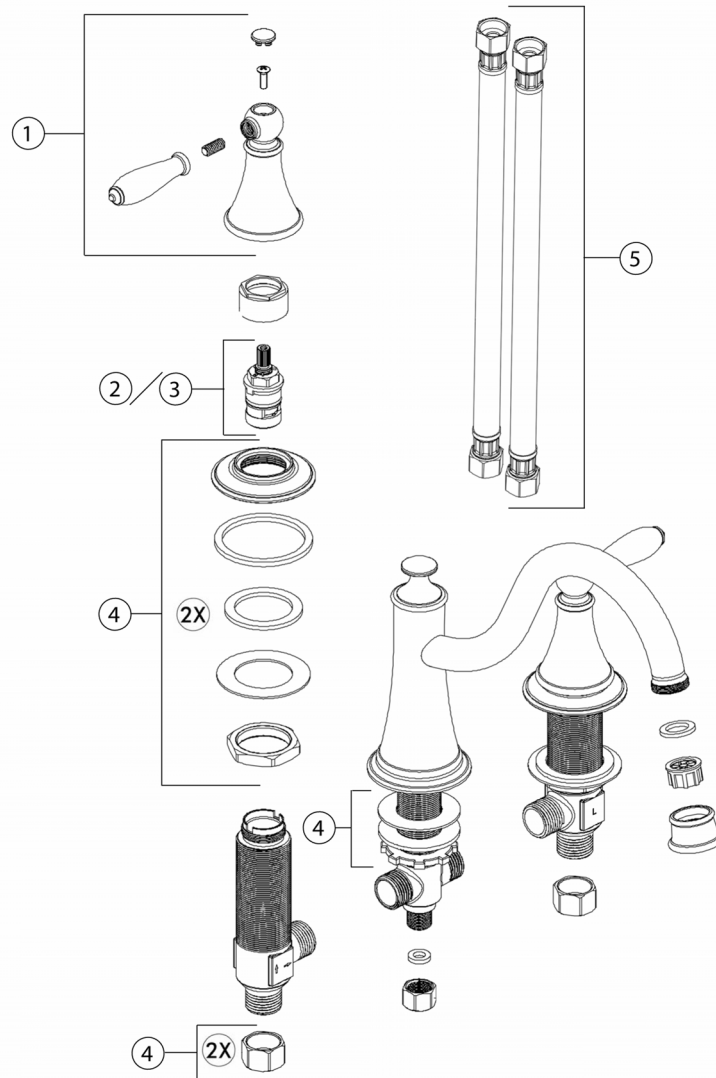
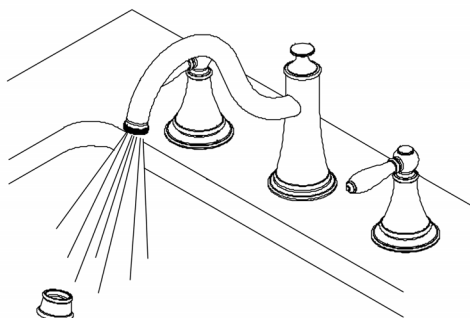

- ① RPG04-0398-(PC,BN,PN)
② RPG05-0889 (HOT VALVE)
③ RPG05-0890 (COLD VALVE)
④ RPG45-0047-(PC,BN,PN)
⑤ RPG63-0085

